

**ADVANCE WARNING
NO RIGHT TURN INTO
DALEGARTH GARDENS →
FOR ACCESS
FOLLOW DIVERSION**

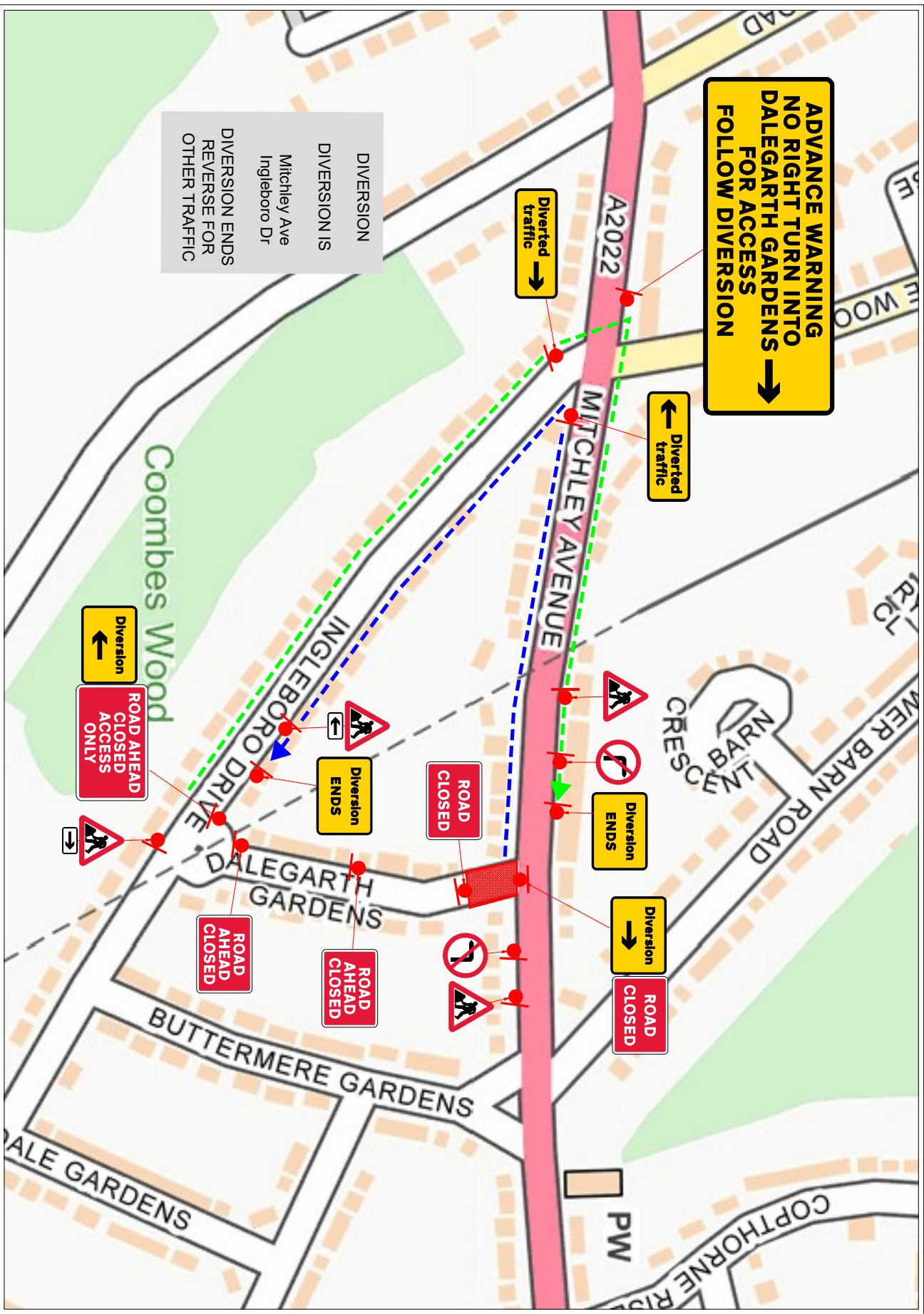

DIVERSION
DIVERION IS
Mitchley Ave
Inglesboro Dr
DIVERION ENDS
REVERSE FOR
OTHER TRAFFIC

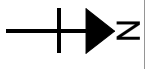

Traffic Management Notes

- 1) All temporary traffic management shall be in accordance with chapter 8 of the Traffic Signs Manual 2009.
- 2) All temporary traffic management shall be in accordance with the Traffic Signs Regulations and General Directions 2016.
- 3) All temporary traffic management shall conform to the Safety at Street Works and Road Works, a code of Practice 2013.
- 4) All temporary traffic management signs should be located 450mm minimum from the left face.
- 5) All temporary traffic management sign locations are indicative and are subject to on-site approval from the Engineer.

This drawing has been produced for the specific client and project identified below and is not intended for use by any other person or for any other purpose (c) Priority TM Ltd
This drawing is a representation of the traffic management systems, which must be installed by qualified personnel. Distances between signs may NOT be to scale for purposes of clarity.
On installations 'Taper Lengths, Safety Zones, Minimum Visibility to first sign & Minimum size of Signs & Cones will conform to C176 Guidelines for the speed of the road.'

KEY

- Works /Excavation
- Safety zone
- 1m Road cones
- Welfare
- Traffic Head
- Aspect of sign view
- Pedestrian barrier
- Pedestrian walkway
- Stop and Go sign
- Road runner barrier
- No Parking cones
- Parking Suspension

UNIT 6
TEMPLE WOOD ESTATE
STOCK ROAD
WEST HAVINGFIELD
CM12 6LP
www.prioritytm.co.uk
Phone: 020 8432 8732
Fax: 020 8305 9189
24hr: 07973 659490
email: Drawings@prioritytm.co.uk

Customer:
forefront
www.forefrontutilities.com

Site Agent/Contact:
Neil Hoad

Site Address:
SOE9721
Dalegarth Gardens J/O
Mitchley Ave
Purley
CR8 1BZ

Speed of Road:
30
20

Drawing Number:
30855-D1-DIV

Scale @A3 1:250
Date Drawn: 04.05.22
Traffic Management:
ROAD CLOSURE
Drawn By: LC
Checked By: RC

PRIORITY
TM Ltd
Traffic Management
020 8432 8732